

Section II.

TM 9-2320-280-24P-1

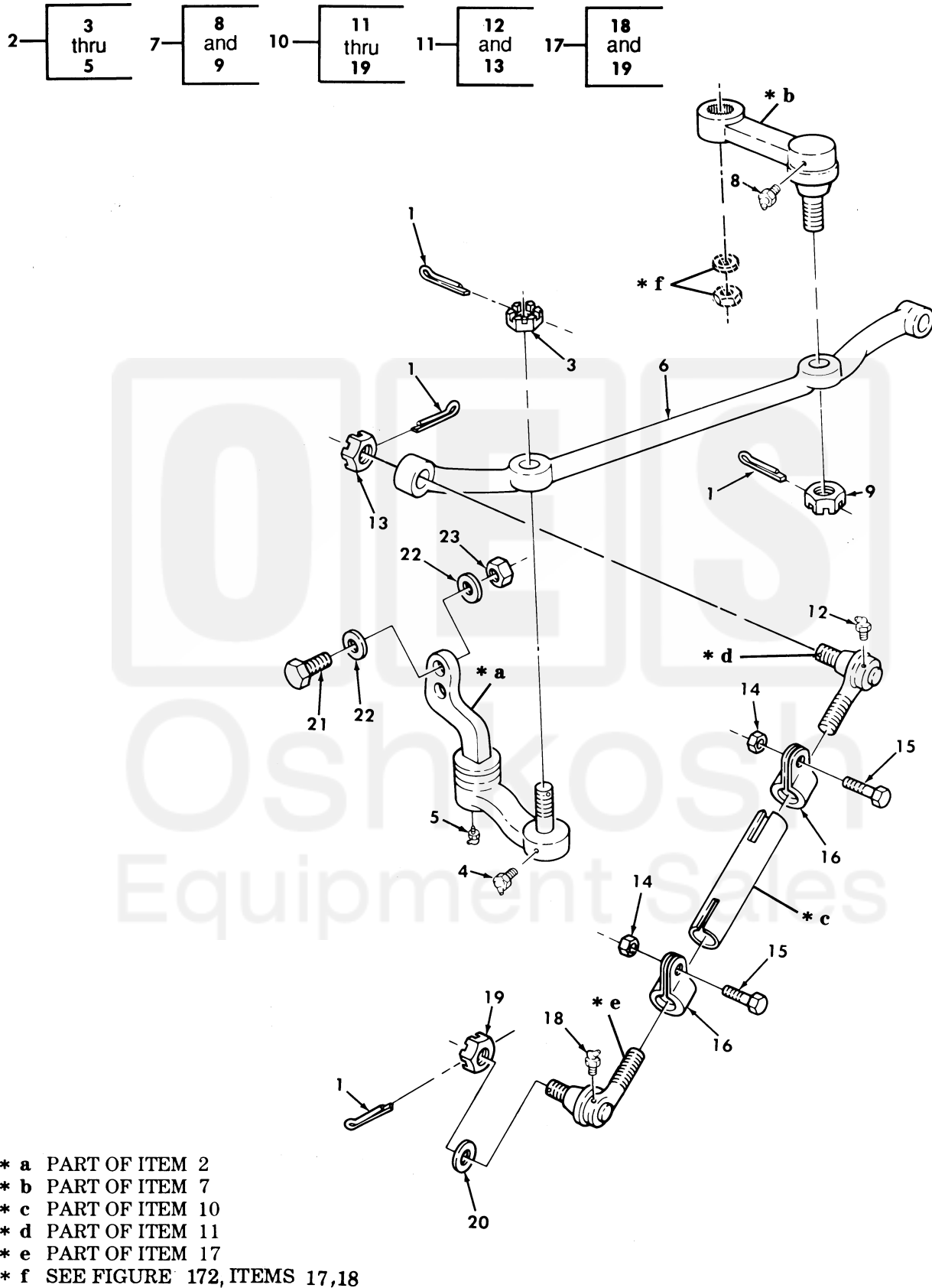

Figure 170. Steering Linkage.

SECTION II		TM9-2320-280-24P				
(1)	(2)	(3)	(4)	(5)	(6)	(7)
ITEM NO	SMR CODE	NSN	CAGEC	PART NUMBER	DESCRIPTION AND USABLE ON CODES(UOC)	QTY
GROUP 1401 MECHANICAL STEERING GEAR ASSEMBLY						
FIG. 170 STEERING LINKAGE						
1	PAOZZ	5315000120123	24617	137195	PIN,COTTER 1.8 X 1-1/4.....	6
2	PAOZZ	2530012491577	98349	L-20-MA-133-A-11	IDLER ARM,STEERING,.....	1
					UOC:AVY,A11,A13,A14,A15,A20,A24,A25,A26,A27,B16,B17,B18,HVY,H11,H13,H14,H15,H16,H17,H18,H20,H21,H24,H25,H26,H27,H28,MMM	
2	PAOZZ	2530014203839	34623	6004839	IDLER ARM,STEERING,.....	1
					UOC:BVY,B15,B20,B24,B25,C17,NNN	
3	PAOZZ	5310008507004	96906	MS35692-54	.NUT,PLAIN,SLOTTED,H 5/8-18.....	1
4	PAOZZ	4730000504203	24617	9417901	.FITTING,LUBRICATION.....	1
5	PAOZZ	4730000504205	7X677	9411030	.FITTING,LUBRICATION.....	1
6	PAOZZ	2530011859651	19207	12338622	DRAG LINK,STEERING.....	1
					UOC:AVY,A11,A13,A14,A15,A20,A24,A25,A26,A27,B16,B17,B18,HVY,H11,H13,H14,H15,H16,H17,H18,H20,H21,H24,H25,H26,H27,H28,MMM	
6	PAOZZ	2530014203837	34623	6003868	DRAG LINK,STEERING.....	1
					UOC:BVY,B15,B20,B24,B25,C17,NNN	
7	PAOZZ	2530012528362	98349	L-20-MA-132-A-11	ARM,STEERING GEAR.....	1
					UOC:AVY,A11,A13,A14,A15,A20,A24,A25,A26,A27,B16,B17,B18,HVY,H11,H13,H14,H15,H16,H17,H18,H20,H21,H24,H25,H26,H27,H28,MMM	
7	PAOZZ	2530014205180	34623	6004838	ARM,STEERING GEAR.....	1
					UOC:BVY,B15,B20,B24,B25,C17,NNN	
8	PAOZZ	4730000504203	96906	MS15001-1	.FITTING,LUBRICATION.....	1
9	PAOZZ	5310008507004	96906	MS35692-54	.NUT,PLAIN,SLOTTED,H 5/8-18.....	1
10	PAOZZ	2530011942049	98349	L-18-VT-5276-B-1	TIE ROD,STEERING L.H. AND R.H.....	2
					UOC:AVY,A11,A13,A14,A15,A20,A24,A25,A26,A27,B16,B17,B18,HVY,H11,H13,H14,H15,H16,H17,H18,H20,H21,H24,H25,H26,H27,H28,MMM	
10	PAOZZ	2530014212563	34623	06005119	TIE ROD,STEERING.....	2
					UOC:BVY,B15,B20,B24,B25,C17,NNN	
11	PAOZZ	2530011892195	98349	L-18-SV-5151-C-1	.TIE ROD END,STEERIN R.H.....	1
					2	
12	PAOZZ	4730000504205	96906	MS15001-3	..FITTING,LUBRICATION R.H.....	1
13	PAOZZ	5310008507004	96906	MS35692-54	..NUT,PLAIN,SLOTTED,H 5/8-18.....	1
14	PAOZZ	5310002416659	96906	MS51943-37	.NUT,SELF-LOCKING,HE 7/16-14.....	2
15	PAOZZ	5305012117478	7X677	9419079	.SCREW,CAP,HEXAGON H 7/16-14 X 1.75	2
16	PAOZZ	5340011918161	98349	L-18-CPS-5-A-10	.CLAMP,LOOP L.H.....	2
17	PAOZZ	2530011972160	98349	L-18-SV-5150-C-1	.TIE ROD END,STEERIN L.H.....	1
					2	
18	PAOZZ	4730000504205	96906	MS15001-3	..FITTING,LUBRICATION L.H.....	1
19	PAOZZ	5310008507004	96906	MS35692-54	..NUT,PLAIN,SLOTTED,H 5/8-18.....	1
20	PAOZZ	5310011517347	24617	2436167	WASHER,FLAT 5/8.....	2
21	PAOZZ	5305007813930	80204	B1821BH038C475N	SCREW,CAP,HEXAGON H 7/16-14 X 4.75.	2
22	PAOZZ	5310008094061	96906	MS27183-15	WASHER,FLAT 7/16.....	4